

#### FEATURES 特 徵

- Type sp in size (10.2 H×19.8W×6.4D mm) and weight (approx.2.2g)  
SP型的尺寸 (10.2 高×19.8寬×6.4深公厘) 和重量(大約2.2克)
- All types are free from OT restriction and permit easy setting.  
所有型式不受操作動程限制，可以容易加以裝置
- Wide switching capacity range from micro voltage/current loads (1mA 125 VAC) to high-capacity loads (3A 250VAC)  
開關容量由小容量(1mA 125 VAC)至大容量(3A 250VAC)

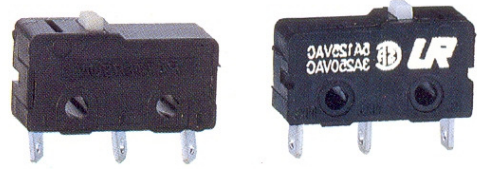

#### RATINGS 規格

Rated voltage 電壓規格	Non-inductive load (A) 非電感性負載				Inductive load (A) 電感性負載				Inrush current (A) 衝擊電流	
	Resistance load 電阻負載		Lamp load 燈泡負載		Inductive load 電感負載		Motor load 馬達負載			
	NC	NO	NC	NO	NC	NO	NC	NO	NC	NO
AC 125	5		1.5	0.7	3		2.5	1.3	20 max.	10 max.
250	3		1.0	0.5	2		1.5	0.8		
DC 8	5		2		4		3		20 max.	10 max.
14	5		2		4		3			
30	4		2		4		3			
125	0.4		0.05		0.4		0.05			
250	0.2		0.03		0.2		0.03			

NOTES:1. Inductive load has a power factor of 0.4min.(AC) and a time constant of 7msec (DC)  
- 電感負載的功率因數為0.4分(交流)一次常數為7毫秒(直流)

2. Lamp load has an inrush current of 10 times the steady-state current, while motor load has an inrush current of 6 times than the steady-state current.  
燈泡負載的衝擊電流是穩定電流的10倍  
馬達負載的衝擊電流是穩定電流的6倍

#### APPROVED BY STANDARDS 認可標準

- UL (File No. E97315)  
SP5-72 Series:  
5A 125VAC, 3A 250VAC  
SP1-72 Series:  
1A 125VAC,
- CSA (File No. LR85888)  
SP5-72 Series:  
5A 125VAC, 3A 250VAC  
SP1-72 Series:  
1A 125VAC

#### CHARACTERISTICS 性能

Operating speed 操作速度	-----	0.1mm to 1m / sec (at plunger)
Operating frequency 操作頻率	-----	400 operations / minute max.
Mechanically	-----	400 operations / minute max.
Contact resistance 接點電阻	-----	30m Ω max.
Basic operating type	-----	30m Ω max.
Insulation resistance 絕緣電阻	-----	100m Ω min.(at 500 VDC).
Dielectric strength 耐電壓	-----	1,000 VAC;50 / 60Hz for 1 minute.
Between contacts	-----	1,000 VAC;50 / 60Hz for 1 minute.
Between terminals and ground	-----	1,500 VAC;50 / 60Hz for 1 minute.
Vibration (Malfunction)	-----	10 to 55Hz;1.5mm double amplitude.
Shock 衝擊	-----	1,000m / s <sup>2</sup> (Approx. 100G)
Mechanical	-----	1,000m / s <sup>2</sup> (Approx. 100G)
Malfunction	-----	300m / s <sup>2</sup> (Approx. 30G)
Ambient temperature 週遭溫度	-----	-25° to +85°C
Humidity 濕度	-----	80% RH max.
Service life 使用壽命	-----	30,000,000 operations / min.
Mechanically	-----	30,000,000 operations / min.
Electrically	-----	200,000 operations / min.

#### 安裝孔

##### Mounting holes

2-2.4 dia mounting holes  
or M2.3 Screw holes  
2.-2.4直徑之安裝孔  
或M2.3螺絲孔 9.50±.01

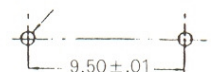

註：各端子之厚度為0.5公厘



#### ORDERING INFORMATION

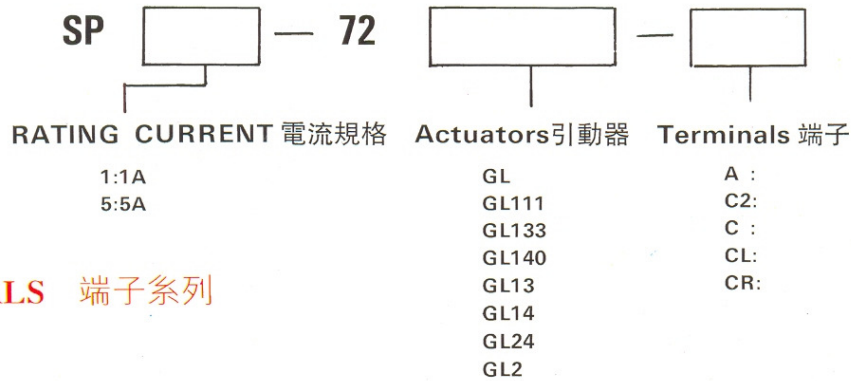

#### TERMINALS 端子系列

Solder terminal (-A) 焊接端子

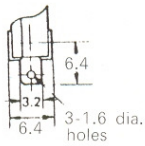

Quick connect terminal (#110) (-C2) 快速接頭端子

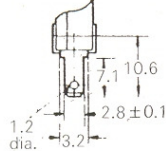

PCB terminal (-C) PC 板端子

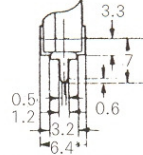

(-CL)

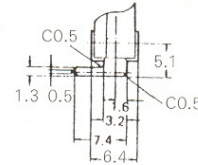

(-CR)

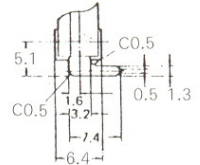

#### DIMENSIONS 外觀尺寸

(Unless otherwise specified, a tolerance of  $\pm 0.4\text{mm}$  applies to all dimensions)  
(除特殊規定外, 所有外觀尺寸容許範圍  $\pm 0.4\text{mm}$ )

##### SP -72- Pin Plunger Type \* (Phenolic resin push button)

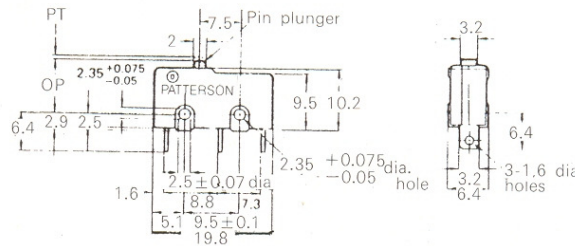
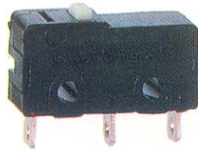

TYPE	SP <input type="text"/> -72- <input type="text"/>
OF max.	150g
RF min.	25g
PT max.	0.5mm
OT min.	0.5mm
MD max.	0.1mm
FP max.	-
OP	8.4 $\pm$ 0.5mm

##### SP -72GL- Standard Lever Type \* (stainless steel lever)

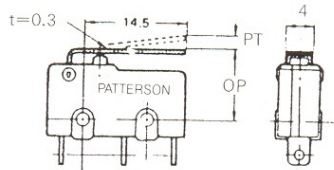
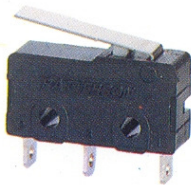

TYPE	SP <input type="text"/> -72GL- <input type="text"/>
OF max.	50g
RF min.	6g
OT min.	1.2mm
MD max.	0.8mm
FP max.	13.6mm
OP	8.8 $\pm$ 0.8mm

##### SP -72GL111- Long Lever Type \* (stainless steel lever)

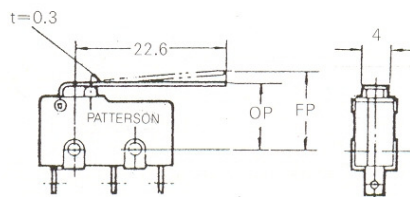
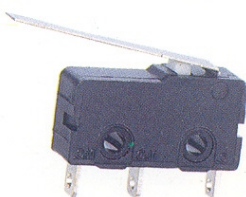

TYPE	SP <input type="text"/> -72GL111- <input type="text"/>
OF max.	50g
RF min.	6g
OT min.	1.2mm
MD max.	0.8mm
FP max.	14.5mm
OP	9.7 $\pm$ 0.8mm



● SP □-72GL133-□ Long Lever Type \* (stainless steel lever)

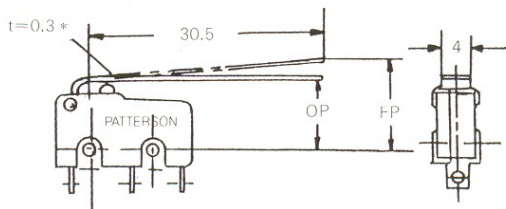
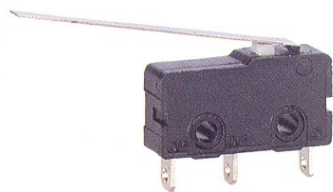

TYPE	SP□-72GL133-□
OF max.	30g
RF min.	5g
OT min.	1.5mm
MD max.	1mm
FP max.	16.5mm
OP	11+6±0.8mm

● SP □-72GL140-□ Long Lever Type \* (stainless steel lever)

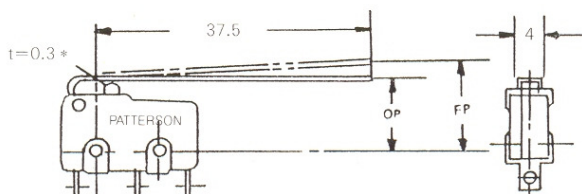
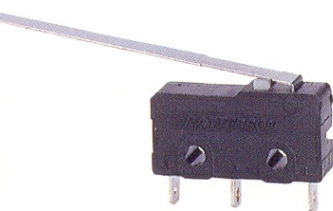

TYPE	SP□-72GL140-□
OF max.	30g
RF min.	5g
OT min.	1.5mm
MD max.	1mm
FP max.	16.9mm
OP	12.0±0.8mm

● SP □-72GL13-□ Simulated Lever Type \* (stainless steel lever)

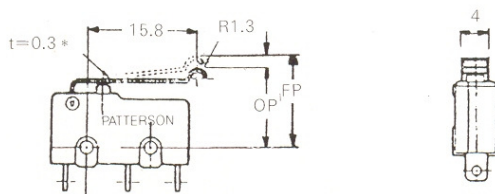
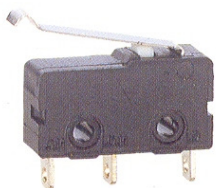

TYPE	SP□-72GL13-□
OF max.	50g
RF min.	6g
OT min.	1.2mm
MD max.	0.8mm
FP max.	15.5mm
OP	10.7±0.8mm

● SP □-72GL14-□ Edge Lever Type \* (stainless steel lever)

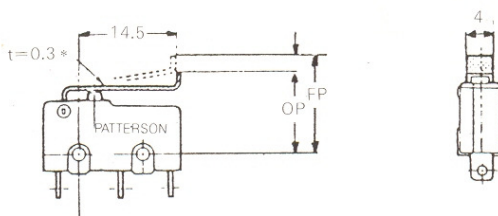
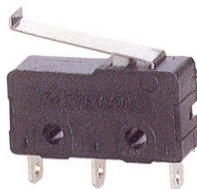

TYPE	SP□-72GL14-□
OF max.	50g
RF min.	6g
OT min.	1.2mm
MD max.	0.8mm
FP max.	14.9mm
OP	10.1±0.8mm

● SP □-72GL24-□ Formed Lever Type \* (stainless steel lever)

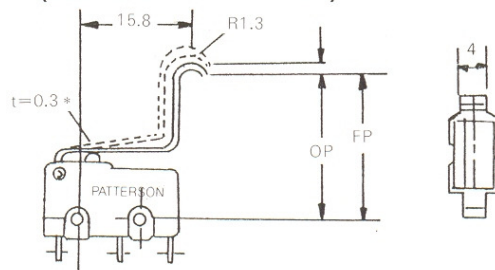
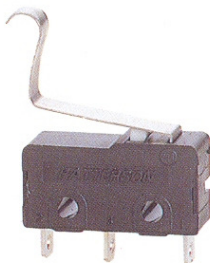

TYPE	SP□-72GL24-□
OF max.	50g
RF min.	6g
OT min.	1.2mm
MD max.	0.8mm
FP max.	24.8mm
OP	22.5±0.8mm

● SP □-72GL2-□ Roller Lever Type \* (stainless steel roller)

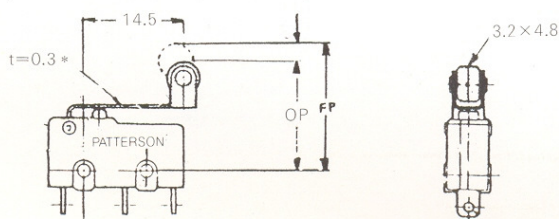
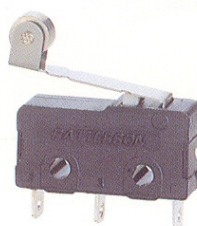

TYPE	SP□-72GL2-□
OF max.	50g
RF min.	6g
OT min.	1.2mm
MD max.	0.8mm
FP max.	19.3mm
OP	14.5±0.8mm