



AC-E75

Rugged Ultra-Slim PIEZO Metal, All Weather, 500 User PIN, Secure Door Access Controller

AC-E75 provides a tough and rugged indoor or outdoor SECURE solution for single door physical access control. No PC required, this model supports 500 user population, smart enroll and delete, 3 security modes. Use with the Secure Series Power Supplies (PC-15T, PS-A15T and PS-B15T), optical tamper, and 2 LED, beeping sounder, with identical programming method to many other Rosslare Products so "Learn one learn'em All !"

GENERAL SYSTEM DESCRIPTION

Designed for high-traffic locations, that require a certain feel of elegance and flush mounted mechanicals, without the need to install a bracket. The AC-E75 is so thin (less than 5 mm), yet so advanced in functionality and features. The AC-E75 PIN secure controller has been designed to be the most **cost effective, anti-vandal, metal, flush-mount** solution for outdoor or indoor residential, commercial, and industrial applications.

The controller is capable of handling up to 500 users, with each user capable of being assigned with one or two codes, providing the capability to have three different security levels.

It is designed for high security applications, due to the fact that lock strike output and Request to Exit input are not located directly on the AC-E75, which eliminates the possibility of unauthorized entry to the restricted area. A multi-purpose Auxiliary input provides more security by generating various Door Alarms and Siren, or other function according to application demands

A specific Power Supply Unit, PC-15T, must be used in conjunction with AC-E75 and be located in the secured physical area. A Secured format, bi-directional communication is used between the two units. The power supply has Door relay output and sounder to generate Bell, Chime and Siren, all activated by AC-E75, and also Request To Exit input which is transmitted to AC-E75. The AC-E75 comes with a "ponytail" 6 Wire Interface and does not need to have the housing opened for installation.

The secure format carries a supervised tamper (optical on the hardware), and Door Bell function is integrated in the power supply.

The AC-E75 is housed in slim, elegant design metal enclosure and completely epoxy potted. It's keypad is flat and widely spaced, and designed to react to the lightest key press, providing the users a quick and comfortable operation.



AC-E75
Ultra-Slim PIEZO Metal
Secure Door Access Controller

SECURE FORMAT COMMUNICATIONS TO REMOTE POWER SUPPLY

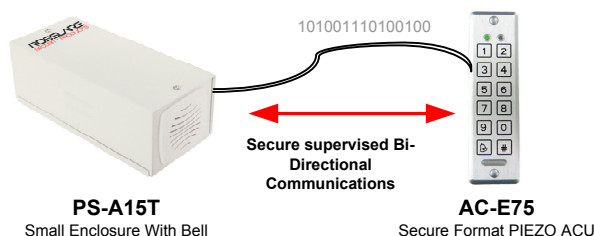

ADVANCED FEATURES

- > Ultra-Slim design let's you flush mount on a flat surface. Unique
- > Up to 500 User Population
- > Bi-directional communication with PC-15T
- > Built in piezoelectric keypad for PIN code entry
- > Standard 2x6 Matrix Keys Keypad for PIN code
- > Internal Buzzer
- > Two Status / Programming LED's .
- > Three User Levels Hierarchy. Normal User Secure User Master User
- > Three Modes of Operation. Normal Mode Bypass Mode Secure Mode
- > "Code Search" feature that helps make maintaining user codes easier.
- > Programmable Lock Output, Siren and alarm delay timers.
- > Programmable Auxiliary Input for Door Alarms generation, Secure Mode entry, or Led Control functions.
- > Request to Exit (REX) signal from PC-15T
- > Comes with mounting template for easier installation.
- > Bell, Chime, Siren, features available with secure PS-15T Power Supply
- > Fully Potted internal construction waterproofs the unit to IP-67 for outdoor use.
- > Built in Optical Back Tamper with Tamper output

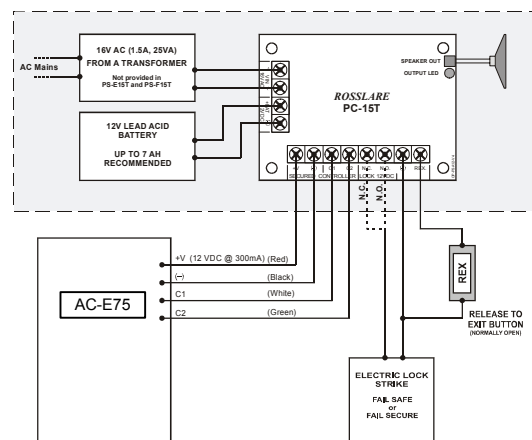

AC-E75 / PC-15T
Typical Interconnection Diagram

SUPERB QUALITY: ISO9001 PROCESS

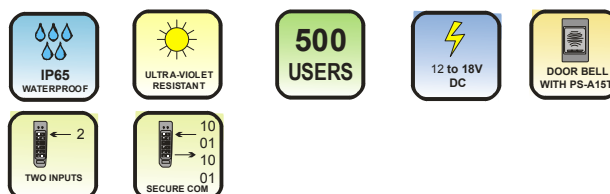

GLUE-LESS SECURE POWER SUPPLY COMPATIBILITY

Rosslare's AC-E75 is directly compatible with the Rosslare PS-15T secure power supply to add Door Bell and Tamper Alarm and Lock Strike Relays for secure functionality of your system.

AC-E75

**Rugged Ultra-Slim PIEZO Metal, All Weather,
500 User PIN, Secure Door Access Controller**

ELECTRICAL CHARACTERISTICS

Operating Voltage Range:
12V DC to 18VDC

Provided from Secure Power Supply
(PC-15T)

DC Battery Charger:

12V DC Lead Acid Battery

Up to 7 Ah recommended

Maximum Input Current at 12V:

AC-E75

Standby: 15 mA

Max: 40 mA

Not including attached devices

Not including attached devices

Relay Outputs:

Provided from Secure Power Supply
(PC-15T)

Local Open Collector Outputs:

Tamper provided from the AC-E75 ACU

Inputs:

REX Provided on Secure Power Supply
(PC-15T)

Local Inputs:

Provided from the AC-E75 ACU

LEDs:

Two Tri-colored LEDs

ENVIRONMENTAL CHARACTERISTICS

Operating Temperature: -25°F to 145°F (-31°C to 63°C)

Operating Humidity: 0 to 95% (Non-Condensing)

Suitable for outdoor use. (IP 65/67)

MECHANICAL CHARACTERISTICS

Dimensions: 6.10" (155 mm) L x 1.73" (44 mm) W x 0.2" (5 mm) D

Weight: 0.330 lbs (150g)

INTERNATIONAL STANDARDS APPROVALS - PENDING

Europe: CE Mark
EN60950

North America: UL-294 Access Control System Unit
FCC Part 15B (Federal Communications Commission)

MECHANICAL DIMENSIONS

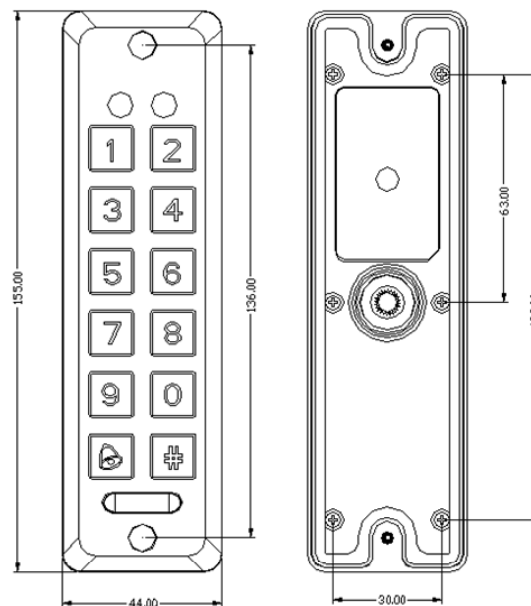

AC-E75
Dimensions and Front Face

AC-E75
Dimensions and Back Face

LABEL INDICATIONS

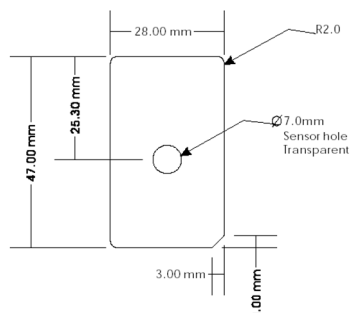

COMPATIBLE ACCESSORIES



PC-15T

Secure Power Supply Unit (PCB Only)



Ex-01

Indoor Egress Button (REX)



PS-B15T

PC-15T Mounted in Enclosure that has
A BELL and can house the backup battery.



PS-A15T

PC-15T Mounted in Small
Enclosure With Bell only

Please refer to the Datasheets
of the individual Accessories
for detailed specifications