

## FEATURES

- Ultra-miniature at 12.5mm x 7.5mm x 10mm(L x W x H)
- 1C configurations
- High sensitivity: 150mW nominal coil power
- Conforms to FCC Part 68 requirements for coil to contacts
- UL and CUL approval, File No.: E179936

## CONTACT DATA

Contact form	1C
Contact resistance (Initial)	100mΩ (voltage drop at 1A/6VDC)
Rated load	0.5A/125VAC
Resistive load(CosΦ = 1)	1A/24VDC
Rated carrying current	2A
Max. switching current	1A
Max. switching voltage	125VAC/60VDC
Max. switching capacity	62.5VA/30W
Min. permissible load	1mA at 5VDC
Contact material	AgPd (Au clad)

## CHARACTERISTICS

Insulation resistance	1000MΩ at 500VDC
Dielectric strength	1000VAC, coil to contacts 400VAC, open contacts
Operate time	5 ms
Release time	5 ms
Vibration resistance	10-55Hz, 3.3mm
Shock resistance	Min. 10G
Humidity	35% to 85%
Ambient temperature	- 30°C to + 70°C
Life expectancy	Electrical: 1 x 10 <sup>5</sup> operations(at rated load) Mechanical: 5 x 10 <sup>6</sup> operations

## COIL SPECIFICATIONS – 1. Standard

Nominal voltage (VDC)	Pick-up voltage VDC (Max.)	Drop-out voltage VDC (Min.)	Nominal current (mA±10% )	Coil resistance (Ω±10% )	Power consumption(mW)	Max. allowable voltage (VDC)
1.5	1.2	0.15	133	11.3	200	160% of nominal voltage
3	2.4	0.3	66.7	45	200	
5	4	0.5	40	125	200	
6	4.8	0.6	33.3	180	200	
9	7.2	0.9	22.2	405	200	
12	9.6	1.2	16.7	720	200	
24	19.2	2.4	8.3	2880	200	

## 2. Low power consumption

Nominal voltage (VDC)	Pick-up voltage VDC (Max.)	Drop-out voltage VDC (Min.)	Nominal current (mA±10%)	Coil resistance (Ω±10% )	Power consumption(mW)	Max. allowable voltage (VDC)
1.5S	1.2	0.15	100	15	150	160% of nominal voltage
3S	2.4	0.3	50	60	150	
5S	4	0.5	30	167	150	
6S	4.8	0.6	25	240	150	
9S	7.2	0.9	16.7	540	150	
12S	9.6	1.2	12.5	960	150	
24S	19.2	2.4	6.25	3840	150	

## ORDERING INFORMATION

ME-3 - 012 - 1Z 3 S

Model No.	Coil Voltage	Contact Form	Termination	Power Consumption
ME-3	1.5VDC-24VDC	1Z: 1C	Nil: PCB Terminal 3: Bent Terminal	Nil: Standard -200mW S: Low power consumption - 150mW

## Dimensions(unit:mm)

Tolerance:  $\pm 0.2$

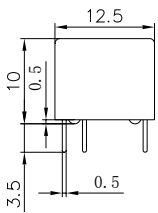

PCB Terminal

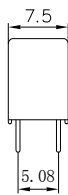

Bent Terminal

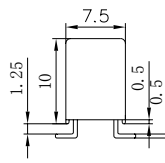

Bottom view  
(PCB LAYOUT)

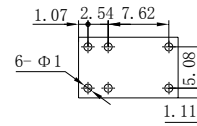

(SCHEMATIC)

